

**WARMAN®**  
Centrifugal Slurry Pumps

Slurry  
Equipment  
Solutions



**SJ Submersible Dewatering Pump**



**Weir Minerals are specialists in delivering and supporting Slurry Equipment Solutions including pumps, hydrocyclones, valves and wear resistant linings for global mining and mineral processing, the power sector, and general industry.**



We use our specialist slurry knowledge and experience from around the world to deliver reliable product and service solutions.

Applying this knowledge to mine and quarry dewatering has resulted in the development of the Warman SJ submersible dewatering pump range offering :

**Trouble free and safe handling**

Warman SJ submersible dewatering pumps are equipped for immediate use. Their robust but low weight design, encapsulated motor and no external moving parts makes installation and operation easy and safe.

**Easy Service and maintenance**

A modular design and common component philosophy throughout the whole range with interchangeable spare parts ensures easy service and maintenance. With simple access to the separate sealed electrical junction box and easily adjusted and replaced wet end parts.

**No suction lift limitations**

Warman SJ dewatering pumps are submersible to 20m depth and as the pump is installed submerged in the pit they have no suction lift limitations, this is superior to any self priming system. The pump does not need to be moved with varying water levels and is designed to run dry in case the water level drops too low. There are no suction hoses, and no vacuum priming issues.

*The Warman SJ submersible dewatering pump range*

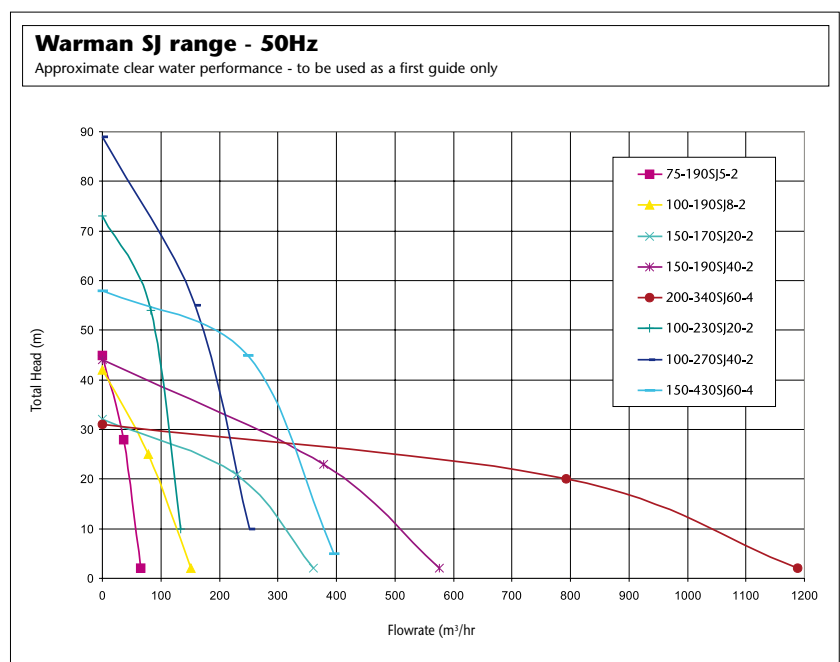

# The premium submersible mine dewatering pump from the global slurry pump specialists

## Ready to use straight from the box

High specification mining cable is supplied as standard

## Can run dry or on snore

Heavy duty construction with double outer casing provides excellent heat convection making it possible to run the pump dry or on snore conditions

## Built in motor protection

All pumps are fitted with bimetal thermal microswitches in each winding. Sizes up to SJ20 have a built-in contactor unit whilst in the SJ40 and SJ60 and all 1000v units the control circuit is included in the main motor cable for external control

## Environmentally safe

Non toxic coatings and the use of white oil ensure that the pump is environmentally safe

## Long life mechanical seal

Silicone carbide faces on primary seal ensure the longest seal life in dirty water conditions

## Wear resistant design

A high chrome iron impeller, nitrile covered motor plate and diffuser and a polyurethane wear plate represent the optimum combination of materials technology for dirty water conditions

## Highly flexible

The pump can operate in any position, upright, horizontal or even upside down

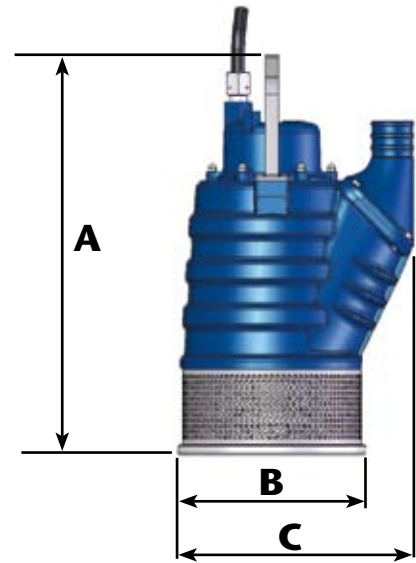
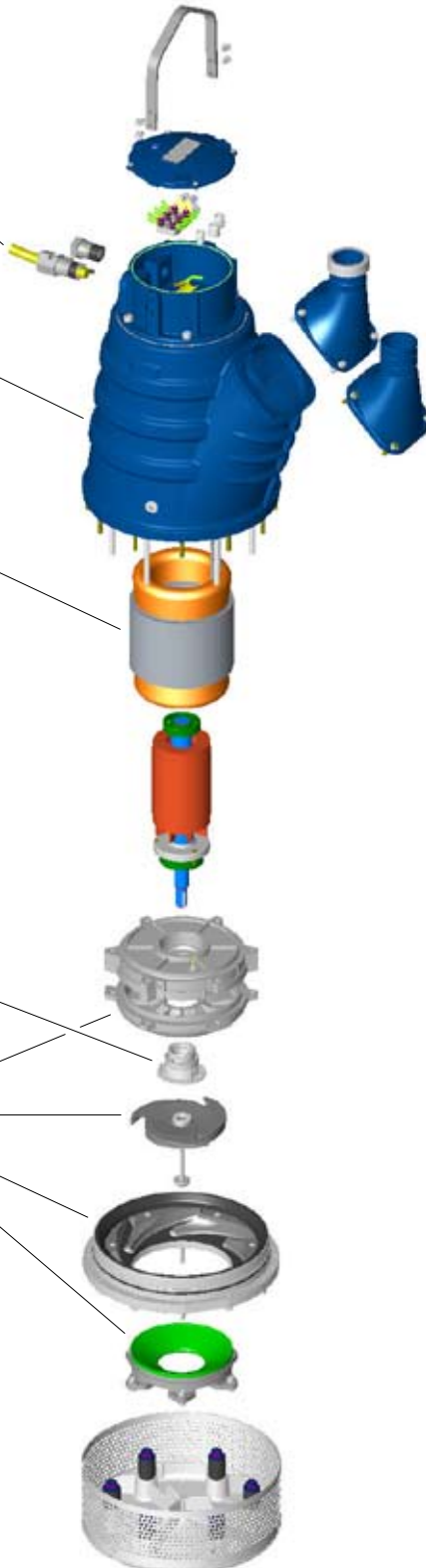

Size	Outlet Dia.	Weight (kg) (incl. cable)	A mm	B mm	C mm
75-190SJ5-2	3",4"	67	686	289	371
100-190SJ8-2	3",4"	87	735	289	374
150-170SJ20-2	4",6",8"	205	960	450	570
100-230SJ20-2	4",6",8"	205	960	450	564
150-190SJ40-2	4",6",8"	335	1195	533	654
100-270SJ40-2	4",6",8"	335	1114	533	646
200-340SJ60-4	6",8"	615	1113	775	907
150-430SJ60-4	6",8"	525	1130	775	960

## Product nomenclature explained :

### 150-190SJ40-2

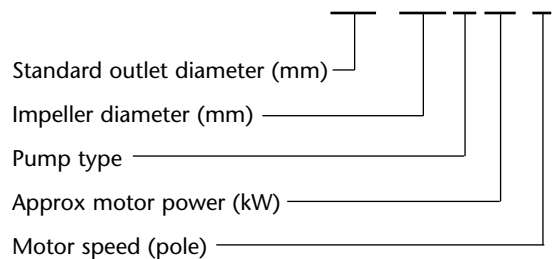

## Geographical footprint

Weir Minerals has the geographical presence to service all the major minerals markets around the world. This global supply capability provides a competitive advantage in this relatively fragmented market.

Weir Minerals has operations across:

- North America
- Europe
- South America
- Australasia
- Africa

## Customer profile

Our customers range from the world's largest minerals and mining multinationals to single site coal producers.

We support customer operations worldwide with consistent products and local engineering expertise. As part of the Weir Group, we have the reach and resource to build close, long term relationships with all our customers, helping them to achieve ...

### The Lowest Cost of Ownership

## Total Care

This global capability with our own dedicated "Total Care" service centres combined with the service centres of our sister companies within the Weir Group and those of our strategic partners provide support in virtually every developed market, close to your mine or quarry site.

**WARMAN®** Centrifugal Slurry Pumps  
**GEHO®** Positive Displacement Slurry Pumps  
**CAVEX®** Hydrocyclones  
**ISOGATE®** Slurry Valves  
**VULCO®** Wear Resistant Linings

For further information on any of these products or Total Care product support services contact your nearest sales office or visit:

[www.weirminerals.com](http://www.weirminerals.com)



In Africa, new technology Warman slurry pumps (post 1991) from Weir Minerals are sold as Envirotech pumps.

### Weir Minerals Europe Limited

Halifax Road  
Todmorden  
Lancashire OL14 5RT  
United Kingdom

Tel.: +44 1706 814 251  
Fax.: +44 1706 815 350  
Email: [sales.uk@weirminerals.com](mailto:sales.uk@weirminerals.com)

Slurry  
Equipment  
Solutions

